

Features

- Breakdown Voltage is DC.20KV.Since the contact is brought out by the lead wires, there is flexibility in its mounting.There are two mounting ears lying either side of the relay, so the relay can be easily fixed and mounted.

Order Code

LRL-102PCZ- $\frac{20}{b}$ KV

a:Coil Voltage 2=12VDC.1=24VDC

b: Breakdown Voltage: 20=DC20KV

Coil Data-Standard Type 1FormA (at 20℃)

Nominal voltage DC $\pm 10\%$ [V]	Coil Resistance $\pm 10\%$ (ohm)	Nominal Current (mA)	Min. Release Voltage (VDC)	Max. Operate Voltage (VDC)
12	85	141.2	1.2	8.4
24	240	100	2.4	19.2

Contact Rating

Contact Form	1FormA
Contact Rating	10W
Switching Voltage	12KV
Max.Switching Current	1.0A
Max.Carry Current	3. 0A

Specification

Contact Resistance	200mΩMAX.(Initial)
Breakdown Voltage	Open contacts DC. 20KV Contacts to coil DC.15KV
Insulation Resistance	$1 \times 10^{12} \Omega$
Electromotive Capacitance	2.0pF MAX.
Operate Time	(Incl.bounce)4.0 mS MAX.(at Nominal Voltage)
Release Time	2.0mS MAX.(at Nominal Voltage)
Vibration	20G(0~55Hz, 1.5mm)
Shock	30G(11mS, 1/2Sin Wave)
Operating Temperature	-20°C ~ +70°C
Storage Temperature	-35°C ~ +90°C
Life Expectancy of Mechanical	1×10^8 MIN. Operations
Life Expectancy of Electrical	DC. 50V-0.5A 5×10^6 MIN. Operations (R.L.)

Dimensions(Unit:mm)

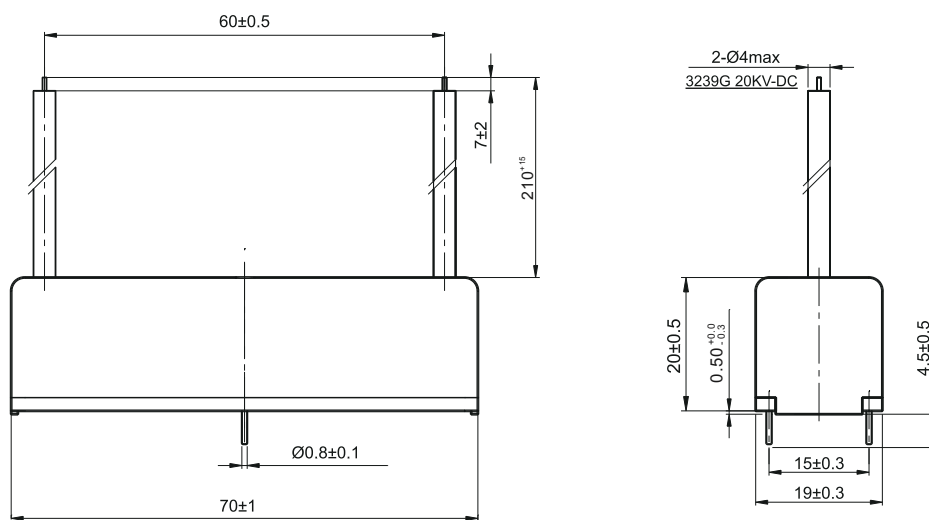

Wiring Diagrams(Top View)

